



General Notes:
(to be read in conjunction with all associated schedules)
Verify all dimensions on site before commencing work or shop drawings.
Do not scale drawings.
Drawings shall be read in conjunction with Engineer's drawings and computations and all structure specified by the Engineer shall be designed.
All work must comply with the National Construction Code Series and Australian Standards, and all other relevant by-laws and authorities.
No work shall be undertaken prior to approval by a registered Certifier.
No footing, or built form to encroach the title boundary.
Location of inground services and overhead power are to be confirmed on site. Achieving minimum clear distances from all services is the responsibility of the contractor.
All works are to be in accordance with relevent local authority approvals. Creative image shown on documentation is indicative only. Final approval of advertising is the responsibility of Bishopp Outdoor Advertising Pty Ltd.

bishopp

BISHOPP OUTDOOR ADVERTISING PTY LTD.

**LOUPE**
ARCHITECTURE

a 313 Cornwall St, Greenslopes QLD 4021
m 0406 272 260 m 0431 518 740
e info@loupearchitecture.com.au
w loupearchitecture.com.au
ABN 96671628345
QLD Registration # 4566 & #
NSW Registration # 12694

GOULBOURN

GOULBOURN GATEWAY SERVICE STATION
CNR SYDNEY RD & COMMON ST GOULBOURN
NSW 2580

LOCATION PLAN

**N**

1:10, 1:1.43 @ A3
Work in Progress

This drawing is copyright and the property of the author and must not be retained, copied or used without the authority of the author. Larger scale drawings and written dimensions take preference. Do not scale from drawings. All dimensions to be checked on site prior to commencement of work. All discrepancies to be brought to the attention of the author.

REV	DATE	DESCRIPTION	AUTHOR
01 - WIP	Work in Progress	ISSUE A	SM

Drawing No	100
Revision	01 - WIP
Project No	2409-12
Stage	CD

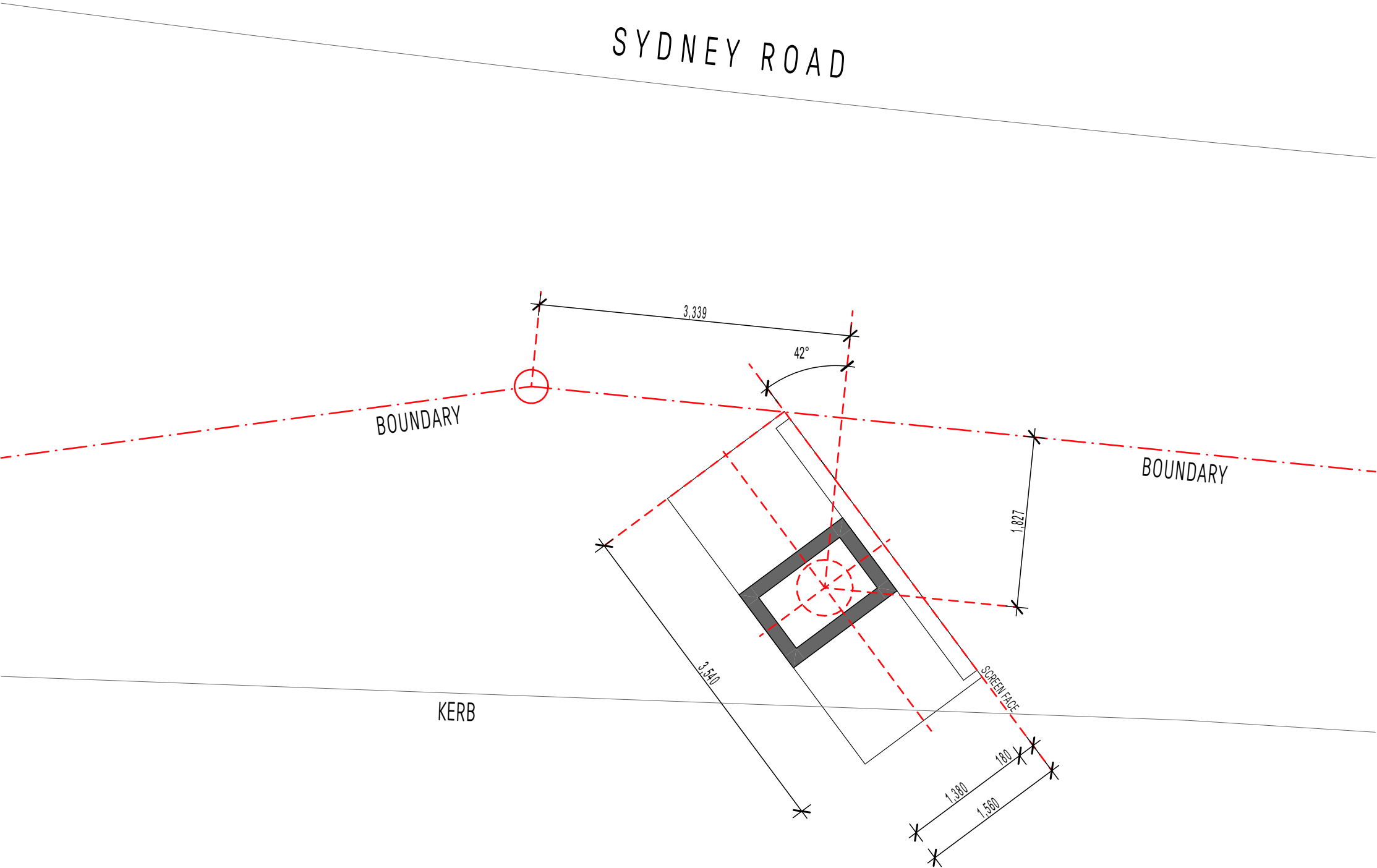

1
-

DETAIL PLAN

1:50

NOTE: SITE PLAN IS INDICATIVE ONLY.
LOCATION OF EXISTING BOUNDARY LINES TO BE IDENTIFIED
AND MARKED BY A LICENCED SURVEYOR.
FINAL SETOUT DIMENSIONS TO BE CONFIRMED IN SITE.
ALL BOUNDARY SETBACKS & INFRASTRUCTURE CLEARANCES
ARE TO BE CONFIRMED WITH LOCAL
AUTHORITY REGULATIONS PRIOR TO CONSTRUCTION.

General Notes:
(to be read in conjunction with all associated schedules)
Verify all dimensions on site before commencing work or shop drawings.
Do not scale drawings.
Drawings shall be read in conjunction with Engineer's drawings and computations and all structure specified by the Engineer shall be designed.
All work must comply with the National Construction Code Series and Australian Standards, and all other relevant by-laws and authorities.
No work shall be undertaken prior to approval by a registered Certifier.
No footing, or built form to encroach the title boundary.
Location of inground services and overhead power are to be confirmed on site. Achieving minimum clear distances from all services is the responsibility of the contractor.
All works are to be in accordance with relevent local authority approvals. Creative image shown on documentation is indicative only. Final approval of advertising is the responsibility of Bishopp Outdoor Advertising Pty Ltd.



BISHOPP OUTDOOR ADVERTISING PTY LTD.



a 313 Cornwall St, Greenslopes QLD 4021
m 0406 272 260 m 0431 518 740
e info@loupearchitecture.com.au
w loupearchitecture.com.au
ABN 96671628345
QLD Registration # 4566 & #
NSW Registration # 12694

GOULBOURN

GOULBOURN GATEWAY SERVICE STATION
CNR SYDNEY RD & COMMON ST GOULBOURN
NSW 2580

SITE PLAN

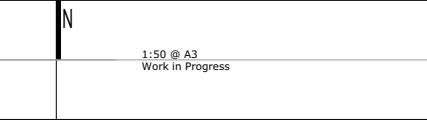

This drawing is copyright and the property of the author and must not be retained, copied or used without the authority of the author. Larger scale drawings and written dimensions take preference. Do not scale from drawings. All dimensions to be checked on site prior to commencement of work. All discrepancies to be brought to the attention of the author.

REV	DATE	DESCRIPTION	AUTHOR
01 - WIP	Work in Progress	ISSUE A	SM

Drawing No	200
Revision	01 - WIP
Project No	2409-12
Stage	CD



PERSPECTIVE VIEW WEST ON SYDNEY ROAD

General Notes:
(to be read in conjunction with all associated schedules)
Verify all dimensions on site before commencing work or shop drawings.
Do not scale drawings.
Drawings shall be read in conjunction with Engineer's drawings and computations and all structure specified by the Engineer shall be designed.
All work must comply with the National Construction Code Series and Australian Standards, and all other relevant by-laws and authorities.
No work shall be undertaken prior to approval by a registered Certifier.
No footing, or built form to encroach the title boundary.
Location of inground services and overhead power are to be confirmed on site. Achieving minimum clear distances from all services is the responsibility of the contractor.
All works are to be in accordance with relevent local authority approvals. Creative image shown on documentation is indicative only. Final approval of advertising is the responsibility of Bishopp Outdoor Advertising Pty Ltd.

bishopp

BISHOPP OUTDOOR ADVERTISING PTY LTD.

**LOUPE
ARCHITECTURE**

a 313 Cornwall St, Greenslopes QLD 4021
m 0406 272 260 m 0431 518 740
e info@loupearchitecture.com.au
w loupearchitecture.com.au
ABN 96671628345
QLD Registration # 4566 & #
NSW Registration # 12694

GOULBOURN

GOULBOURN GATEWAY SERVICE STATION
CNR SYDNEY RD & COMMON ST GOULBOURN
NSW 2580

PERSPECTIVE VIEW

Work In Progress

This drawing is copyright and the property of the author and must not be retained, copied or used without the authority of the author. Larger scale drawings and written dimensions take preference. Do not scale from drawings. All dimensions to be checked on site prior to commencement of work. All discrepancies to be brought to the attention of the author.

REV	DATE	DESCRIPTION	AUTHOR
01 - WIP	Work in Progress	ISSUE A	SM

Drawing No	220
Revision	01 - WIP
Project No	2409-12
Stage	CD

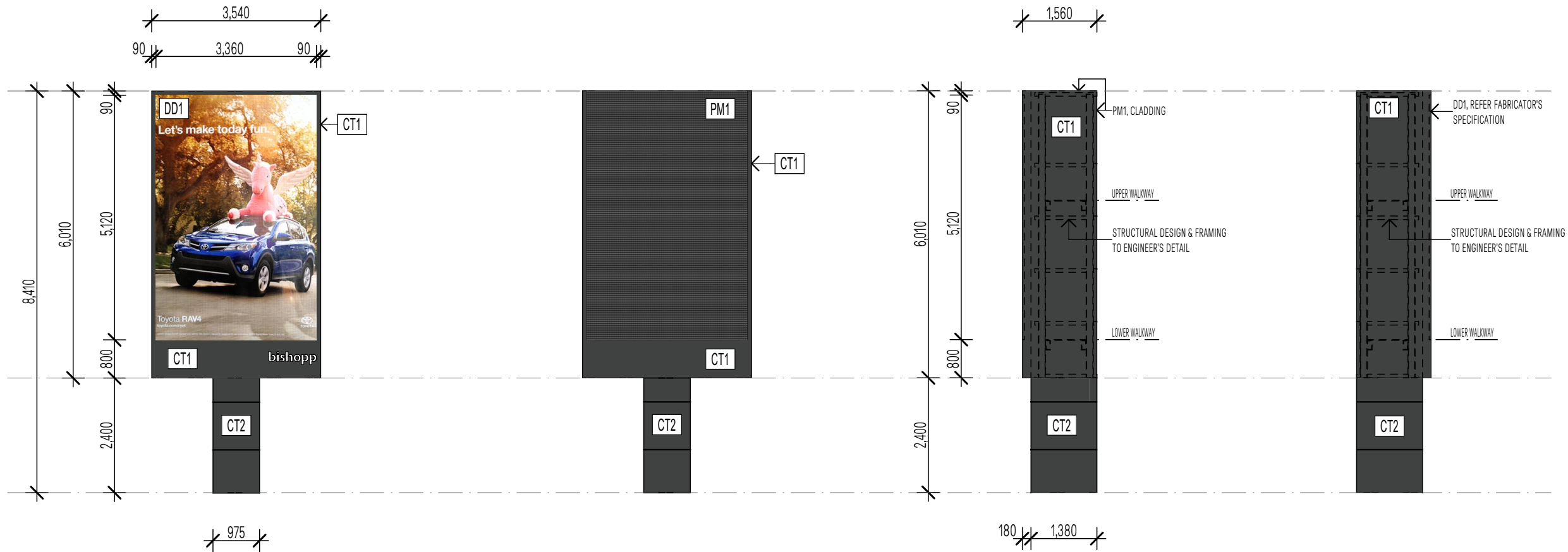

1
-
3X6_V FRONT ELEVATION (DIGITAL DISPLAY)
1:100

2
-
3X6_V REAR ELEVATION
1:100

3
-
3X6_V SIDE ELEVATION 1
1:100

4
-
3X6_V SIDE ELEVATION 2
1:100

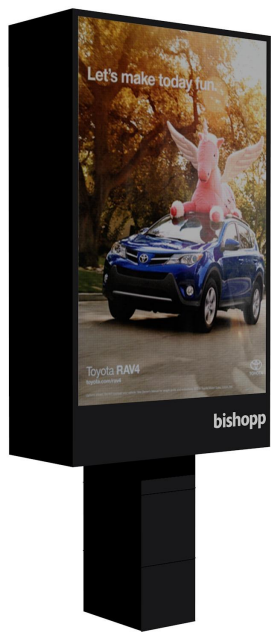

6
-
3X6_V 3D VIEW FRONT



7
-
3X6_V 3D VIEW REAR

CODE	DESCRIPTION	SPECIFICATION	COLOUR	IMAGE
CT1	CLADDING TYPE ONE	SOLID ALUMINIUM CLADDING SPECIFICATION Thickness to fabricator's specification Finish: proprietary powdercoat system for marine environments.	Colour to match Colorbond 'Monument'	
CT2	CLADDING TYPE TWO	PYLON CLADDING SPECIFICATION Vitrapanel Thickness: 9mm Finish: Pre-finished Coatings: Single-sided	Colour to match Colorbond 'Monument'	
PM1	PERFORATED METAL TYPE	PERFORATED METAL SPECIFICATION Locker Group Perforated Aluminium screening Code: R09540A530. Open Area: 40% Thickness: to fabricator's specification. Finish: Powdercoat (marine grade finish to coastal environments) Proprietary rubber separation system at all fixing points. All screens are to custom made. Allow for 50mm margin at perimeter.	Colour to match Colorbond 'Monument'	
DD1	DIGITAL DISPLAY TYPE	DIGITAL DISPLAY SCREEN SPECIFICATION Refer to fabricator's specification		

General Notes:
(to be read in conjunction with all associated schedules)
Verify all dimensions on site before commencing work or shop drawings.
Do not scale drawings.
Drawings shall be read in conjunction with Engineer's drawings and computations and all structure specified by the Engineer shall be designed.
All work must comply with the National Construction Code Series and Australian Standards, and all other relevant by-laws and authorities.
No work shall be undertaken prior to approval by a registered Certifier.
No footing, or built form to encroach the title boundary.
Location of inground services and overhead power are to be confirmed on site. Achieving minimum clear distances from all services is the responsibility of the contractor.
All works are to be in accordance with relevent local authority approvals. Creative image shown on documentation is indicative only. Final approval of advertising is the responsibility of Bishopp Outdoor Advertising Pty Ltd.

BISHOPP OUTDOOR ADVERTISING PTY LTD.

a 313 Cornwall St, Greenslopes QLD 4021
m 0406 272 260 m 0431 518 740
e info@loupearchitecture.com.au
w loupearchitecture.com.au
ABN 96671628345
QLD Registration # 4566 & #
NSW Registration # 12694

GOULBOURN

GOULBOURN GATEWAY SERVICE STATION
CNR SYDNEY RD & COMMON ST GOULBOURN
NSW 2580

PROPOSED ELEVATIONS

Work In Progress			
This drawing is copyright and the property of the author and must not be retained, copied or used without the authority of the author. Larger scale drawings and written dimensions take preference. Do not scale from drawings. All dimensions to be checked on site prior to commencement of work. All discrepancies to be brought to the attention of the author.			
REV	DATE	DESCRIPTION	AUTHOR
01 - WIP	Work In Progress	ISSUE A	SM

Drawing No	300
Revision	01 - WIP
Project No	2409-12
Stage	CD